

# SIDE CHANNEL BLOWERS

## BL 320 002 – Double Impeller



Construction of the ring blowers fans is based on the lateral ducts principle. The blowers can operate as either exhaust or compression fans and are designed for continuous service. The device is assembled directly on the motor shaft; all the rotating parts are dynamically balanced to ensure absolute absence of vibration. Full die-cast aluminum construction for maximum sturdiness and ease of handling. The characteristics data given here refer to the handling of gas with inlet temperature of 15°C, normal density of 1,23 kg/m<sup>3</sup> and absolute pressure of 1023 mbar. Tolerance of ±10%.

Model	Freq. [Hz]	Power [kW]	Voltage [V]		Rated Current [A]		Max Airflow [m <sup>3</sup> /h]	Rated VACUUM [mbar]	Rated COMPRESSOR [mbar]	Noise [dB A]	Weight [kg]
			△	Y	△	Y					
BL32000200700	50	0.70	200÷240	345÷415	3.8	2.2	88	-210	240	55	15
	60	0.83	220÷275	380÷480	3.75	2.15	102	-250	250	61	
BL320002M0700	50	0.7	220÷240		4.5		88	-210	240	55	16
	60	0.83			5.6		103	-250	250	61	

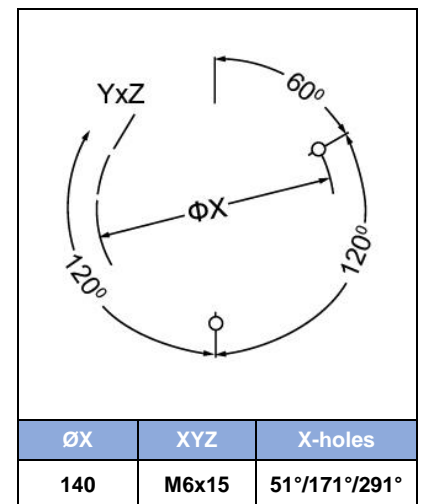
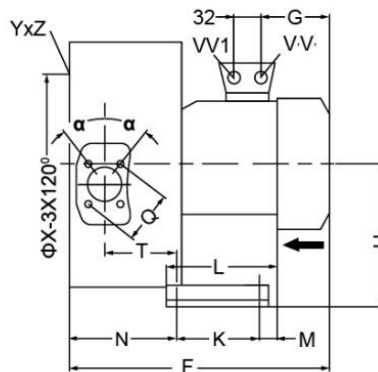
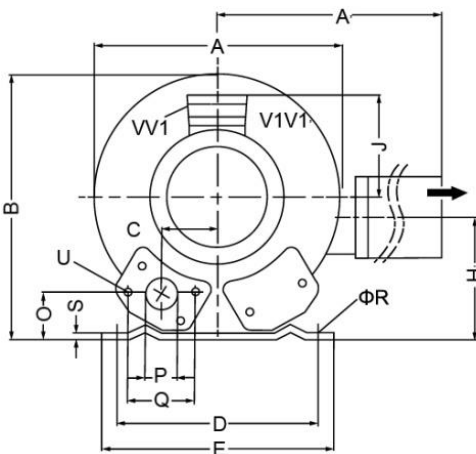
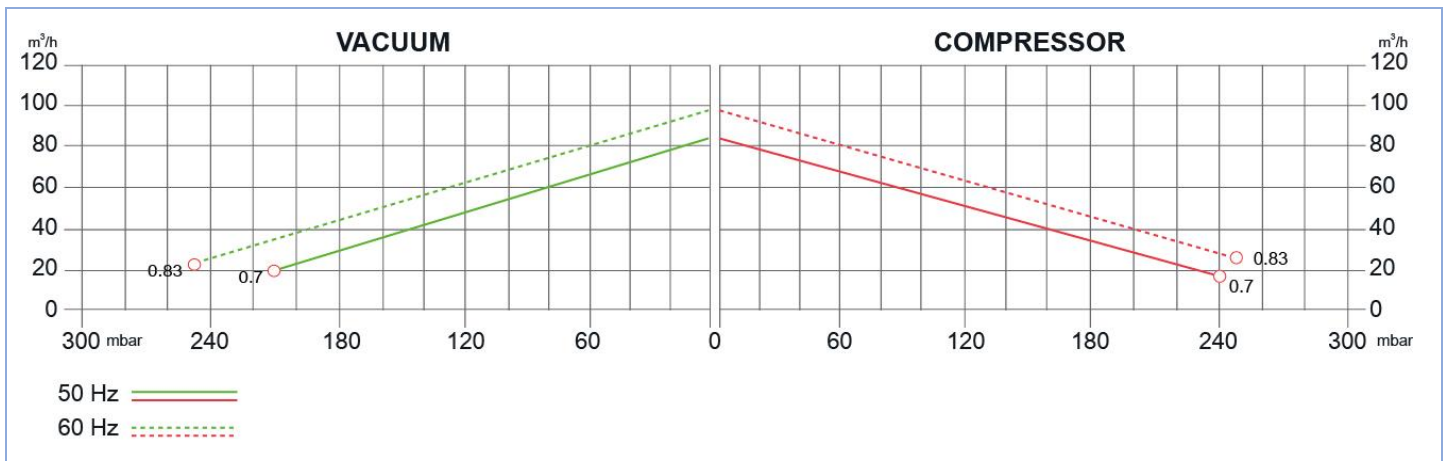

MODEL	A	A'	B	C	D	E	F	G	H	H'	J	K	L	M	N	O	P	Q	ØR	S	T	U	(1-)		(3-)		α
																							V	V	V	V1	
BL32000200700	284	316	270	45	205	230	316	135	128	106	111	83	108	75	130	39	G 1/4	64	10	2.8	88	M6x7			M25X1.5	M16X1.5	27
BL320002M0700																							M16X1.5	M25X1.5			

# SIDE CHANNEL BLOWERS

## BL 320 002 – Double Impeller

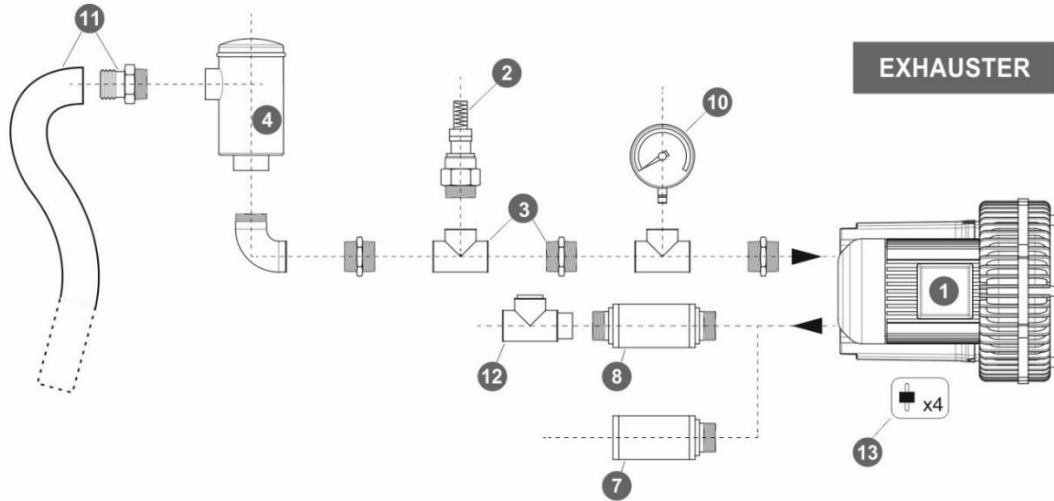

Ref. #	Description	Code
1	Side Channel Blower Double Impeller / Double Stage – 1"¼ connection	BL 320 002
2	Safety Valve	BLSV032L02
3	Installation kit safety valve	BLKS032032C
4	In-Line filter	Paper Polyester Stainless Steel 30 µ Stainless Steel 60 µ
5	Cartridge filter	BLCF032PA007
6	Filter kit	Nipple Socket
7	Final Silencer	BLFS032ZP - BLFS032ZPR
8	In-Line silencer	BLIS125
9	Indoor filter	BLIF032ZP100
10	Gauge	Pressure Vacuum
11	Sleeve + Hose clip kit	BLSH032
12	Check valve	BLCV032AL
13	Anti-vibration pins	BLAV06

