

### SPECIFICATIONS:

**MODEL NUMBER:** 8010-252-136

**PUMP DESIGN:** Positive Displacement 3 Chamber Diaphragm Pump

**CHECK VALVE:** (1-Way Operation) Prevents Reverse Flow

**CAM:** 2.5 Degree

**MOTOR:** Permanent Magnet, P/N 11-142-20, Thermally Protected

**VOLTAGE:** 24 VAC Nominal

**PRESSURE SWITCH:** Adjustable Shut-Off (Range 40-60 PSI)

Factory Set @ 60 PSI, Turn On 45 PSI  $\pm$  5 PSI

**LIQUID TEMPERATURE:** 170 Degrees Fahrenheit (77 Degrees Centigrade) Max.

**PRIME:** Self-Priming Up To 7.0 Ft. Vertical,

Max. Inlet Pressure 30 PSI (2.1 Bar)

**PORTS:** 3/8"-18 NPT Female

**MATERIAL OF CONSTRUCTION:**

**PLASTICS-** Polypropylene

**VALVES-** EPDM

**DIAPHRAGM-** Santoprene

**FASTENERS-** Stainless Steel

**NET WEIGHT:** 3.8 Lbs (1.72 Kg)

**DUTY CYCLE:** Intermittent (See Temperature Rise Chart)

**APPROVALS:** NSF Listed

**TYPICAL APPLICATIONS:** Booster Pump, Water Delivery

### DIMENSIONS:

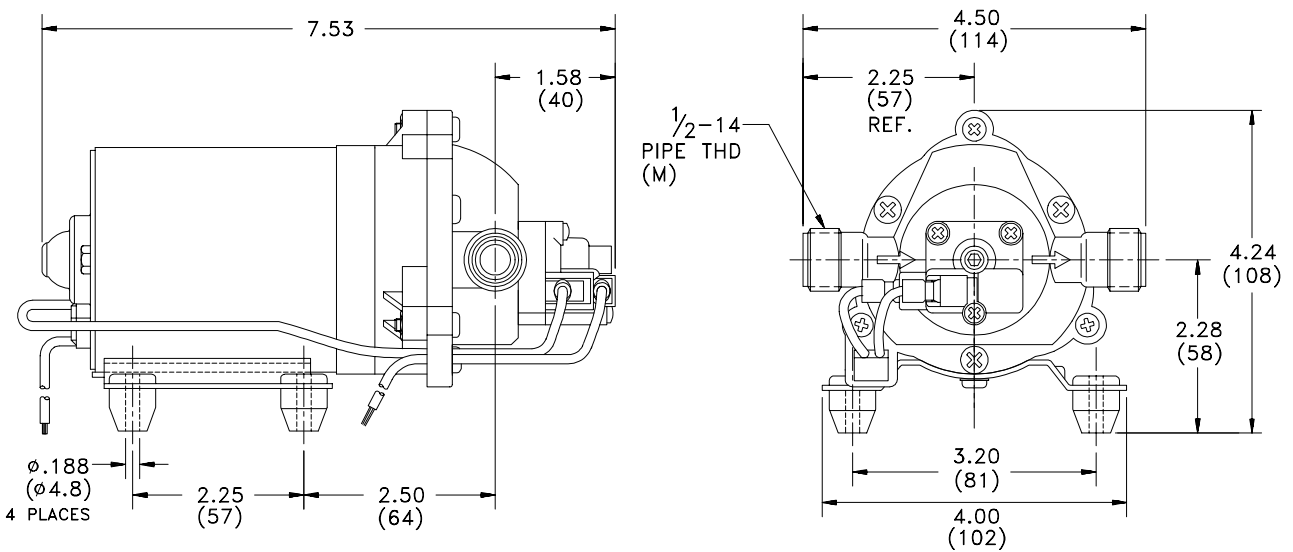

**TEMPERATURE RISE**

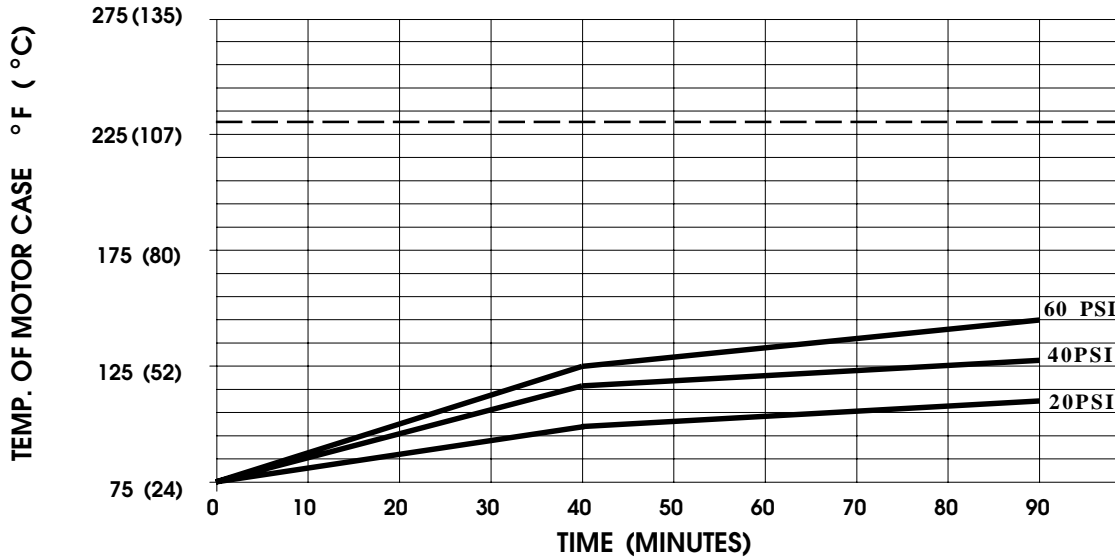

THIS GRAPH IS FOR USE AS A DESIGN GUIDE. IT IS BASED ON RUNNING CONTINUOUSLY WITH AN AMBIENT TEMPERATURE OF 75 °F IN STILL AIR. THE THERMAL BREAKER WILL OPEN WHEN THE CASE TEMPERATURE REACHES 230 °F.

[- - - - - TRIP POINT OF THERMAL PROTECTOR]

**TYPICAL PERFORMANCE**

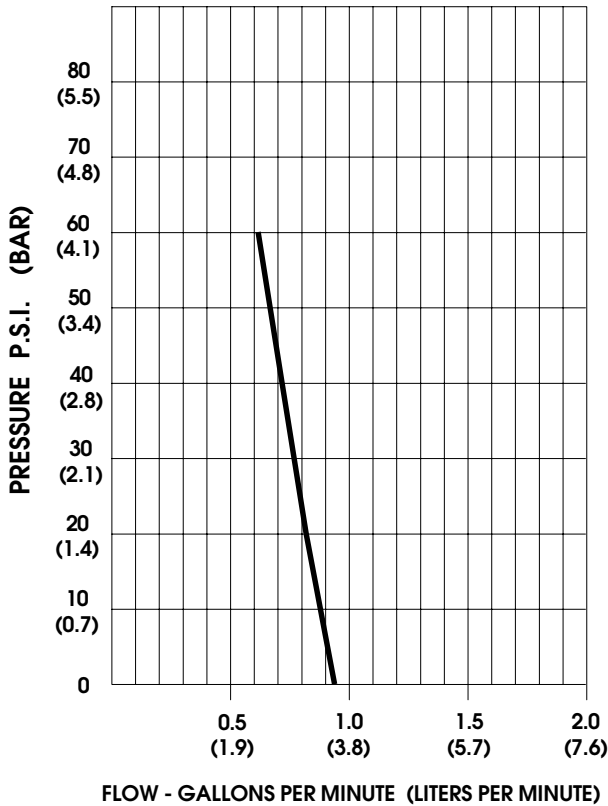

PRESSURE (PSI)	FLOW (GPM/LIT)	RPM MIN/MAX	CURRENT (AMPS)	VOLTAGE (VOLTS)
OPEN	0.95/3.6	1555/1625	0.82	24VAC
10	0.87/3.3	1500/1570	0.99	"
20	0.82/3.1	1445/1515	1.21	"
30	0.75/2.8	1385/1460	1.43	"
40	0.72/2.7	1325/1420	1.62	"
50	0.66/2.5	1290/1375	1.81	"
60	0.62/2.3	1240/1330	1.98	"

-SPECIFICATIONS SUBJECT TO CHANGE WITHOUT NOTICE.

-ALL DATA BASED ON TESTING WITH WATER AT AMBIENT TEMPERATURE.